

380-1

PARTS BOOK

model

NAKAJIMA Model 380

From the library of: Diamond Needle Corp

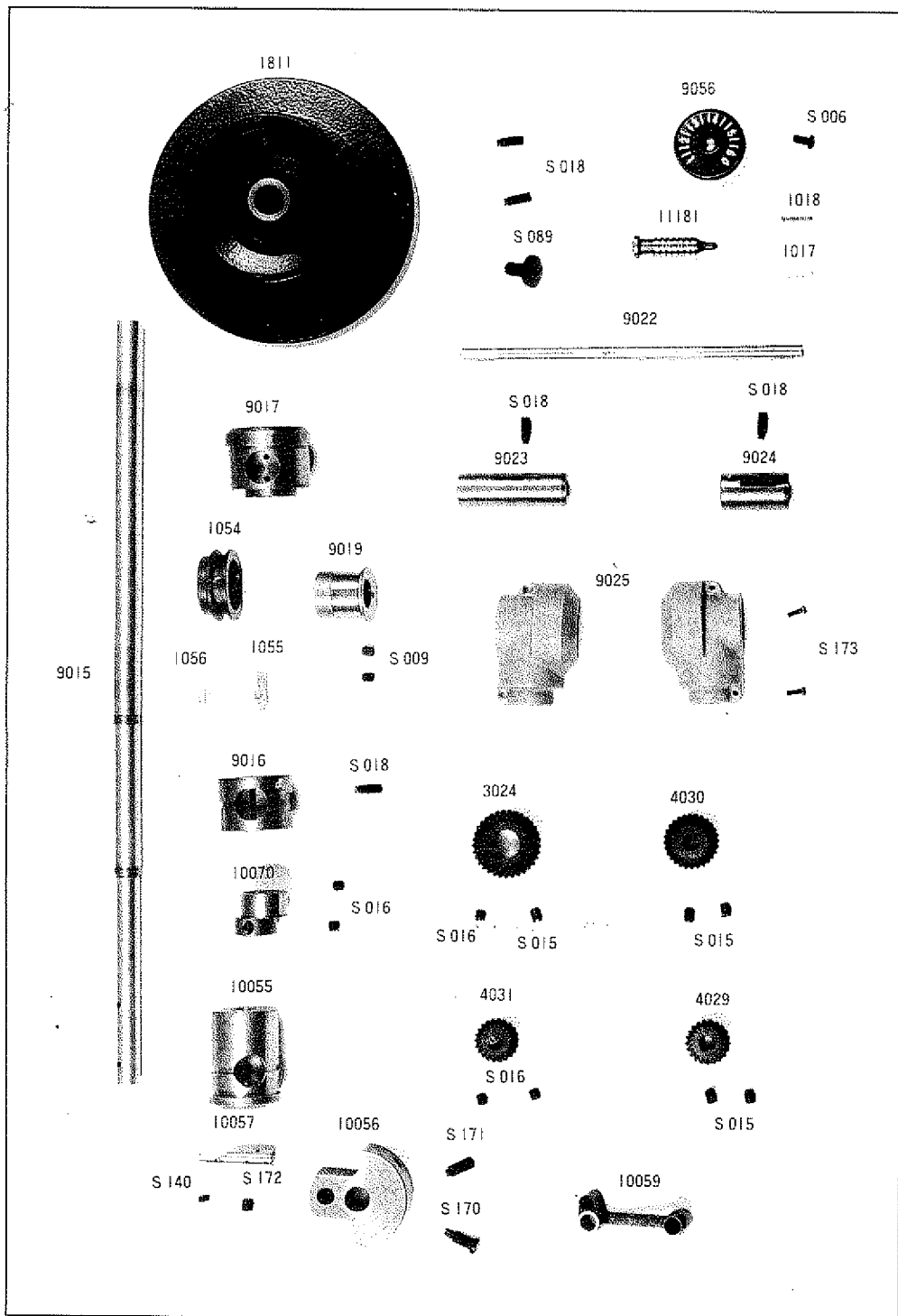

品番 Part. No.	品名	Description	数量 Amt. Req.
1017	送り調節ピン	Feed regulator stop pin	1
1018	送り調節ピンバネ	Feed regulator stop pin spring	1
1054	二又サヤ	Feed drive eccentric cam ring	1
1055	二又サヤフェルト	Oil felt	1
1056	二又サヤフェルト押エ	Oil felt spring	1
1811	ハズミ車	Balance wheel	1
S089	" 押ネジ	··· Screw	1
S018	" 止ネジ	··· Screw	1
3024	上傘歯車(大)	Main shaft gear	1
S016	" 止ネジ	··· Screw	1
S015	" 止ネジ	··· Screw	5
4029	上傘歯車(小)	Upright shaft upper gear	1
4030	下傘歯車(大)	Upright shaft lower gear	1
4031	下傘歯車(小)	Hook driving shaft gear	1
S016	" 止ネジ	··· Screw	2
9015	上軸	Main shaft	1
9016	上軸中メタル	Main shaft intermediate bushing	1
S018	" 止ネジ	··· Screw	1
9017	上軸後メタル	Main shaft rear bushing	1
9019	送り偏心カム	Feed eccentric cam	1
S009	" 止ネジ	··· Screw	2
9022	立軸	Upright shaft	1
9023	立軸上メタル	Upright shaft upper bushing	1
S018	" 止ネジ	··· Screw	2
9024	立軸下メタル	Upright shaft lower bushing	1
9025	上歯車ケース	Main shaft gear case	1
S173	" 止ネジ	··· Screw	2
9056	目盛板	Stitch dial	1
S006	" 止ネジ	··· Screw	1
10055	上軸前メタル	Main shaft front bushing	1
10056	釣合錘	Balance weight	1
S170	" 止ネジS	··· Screw(S)	1
S171	" 止ネジ	··· Screw	1
10057	針棒クランクピン	Needle bar crank pin	1
S140	" 止ネジ(1)	··· Screw(1)	1
S172	" 止ネジ(2)	··· Screw(2)	1
10059	針棒クランクロッド	Needle bar crank rod	1
10070	上送りカム	Lifting eccentric cam	1
S016	" 止ネジ	··· Screw	2
11181	送り調節ネジ	Feed regulating screw	1

From the factory of Diamond Needle Corp

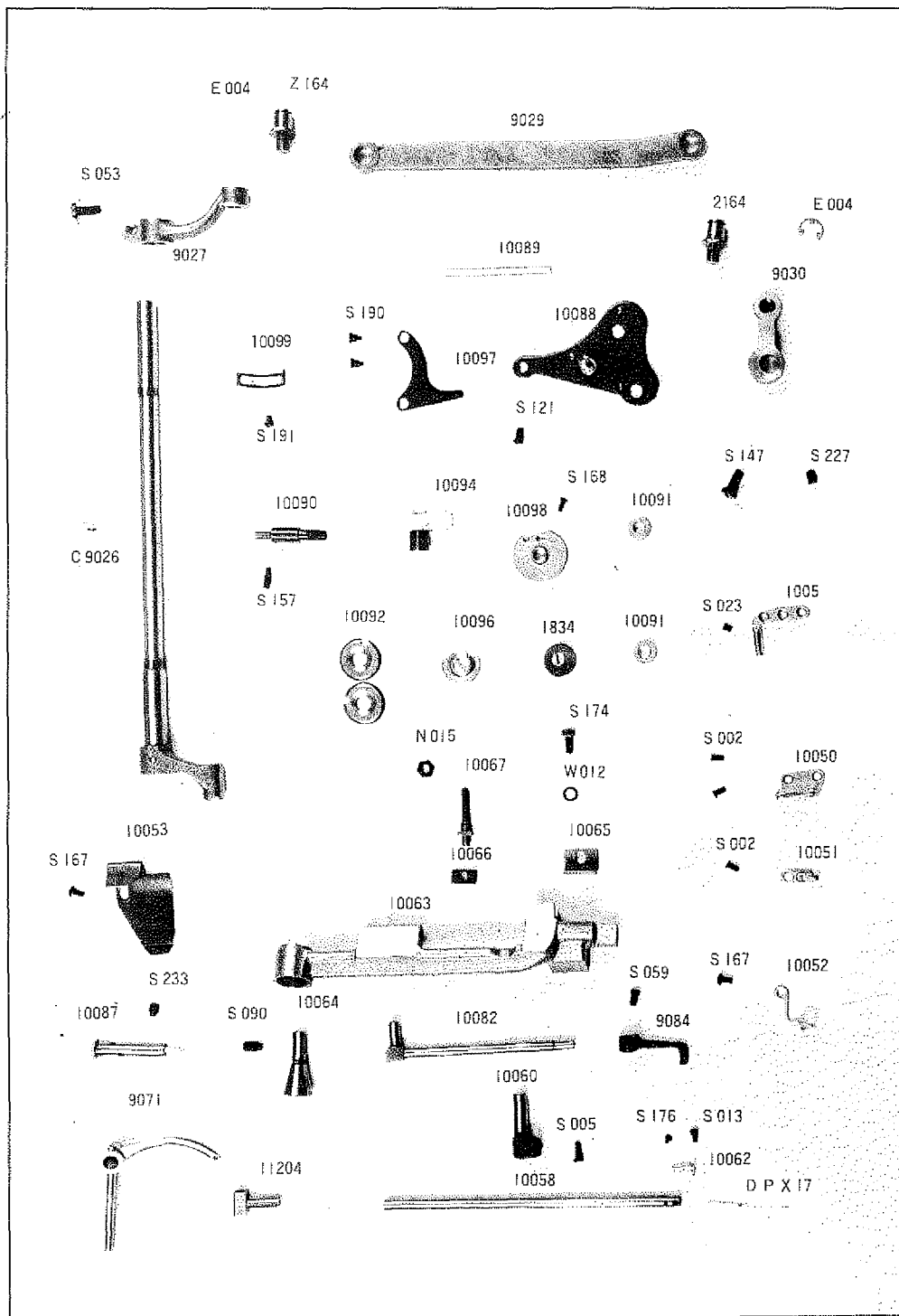

品番 Part.No.	品名	Description	数量 Amt.Reg.
1834	糸調子バネ	Tension spring	1
1005	三ッ目糸掛ケ	Thread retainer	1
S023	" 止ネジ	Screw	1
C9026	針棒揺動軸	Needle bar frame rock shaft	1
9027	針棒揺動後部腕	Needle bar shaft rear crank	1
S053	" 締ネジ	Screw	1
9029	針棒揺動ロッド	Needle bar frame driving rod	1
2164	" 段ネジ	Screw stud	2
E004	" Eリング	Snap ring	2
9030	針棒揺動送り腕	Needle bar frame driving crank	1
S227	" 止ネジA	Screw(A)	1
S147	" 止ネジB	Screw(B)	1
9071	天秤	Thread take-up lever	1
9084	上送り足	Walking foot	1
S059	" 締ネジ	Screw	1
10050	糸案内上	Upper frame thread guide	1
S002	" 止ネジ	Screw	3
10051	糸案内中	Middle frame thread guide	1
10052	糸案内下	Lower frame thread guide	1
S167	" 止ネジ	Screw	2
10053	天秤油防板	Take-up oil splasher	1
10058	針棒	Needle bar	1
10060	針棒抱キ	Needle bar connection	1
S005	" 締ネジ	Screw	1
10062	針棒糸掛	Needle bar thread guide	1
S176	" 止ネジ	Screw	1
DPX17	針 #18	Needle #18	1
S013	" 止ネジ	Screw	1
10063	針棒揺動台	Needle bar frame	1
10064	針棒揺動台軸	Needle bar frame stud	1
S090	" 止ネジ	Screw	1
10065	揺動台案内	Needle bar frame guide	1
S174	" 止ネジ	Screw	1
W012	" 座金	Washer	1
10066	針棒揺動角ゴマ	Needle bar frame slide block	1
10067	針棒揺動角ゴマ軸	Screw stud	1
N015	" ナット	Nut	1
10082	上送り棒	Walking bar	1
10087	天秤支エ軸	Take-up lever pin	1
S233	" 止ネジ	Screw	1
10088	糸調子台板	Tension controller base	1
S121	" 止ネジ	Screw	1
10089	糸ユルメ押し棒	Tension release bar	1
10090	糸取りバネ軸	Take-up spring stud	1
S157	" 止ネジ	Screw	1
10091	糸調子ナット	Thread tension stud nut	2
10092	糸調子皿	Tension disc	2
10094	糸取りバネ	Thread take-up spring	1
10096	糸調子皿押エ	Tension disc holder	1
10097	糸ユルメ受板	Tension releas lever	1
S190	" 段ネジ	Screw	2
10098	糸取りバネ案内皿	Take-up spring guide disc	1
S188	" 止ネジ	Screw	1
10099	糸取りバネ調節板	Take-up spring adjusting plate	1
S191	" 止ネジ	Screw	1
11204	天秤スライド軸	Take-up lever thrust pin	1

From the library of: Diamond Needle Co.

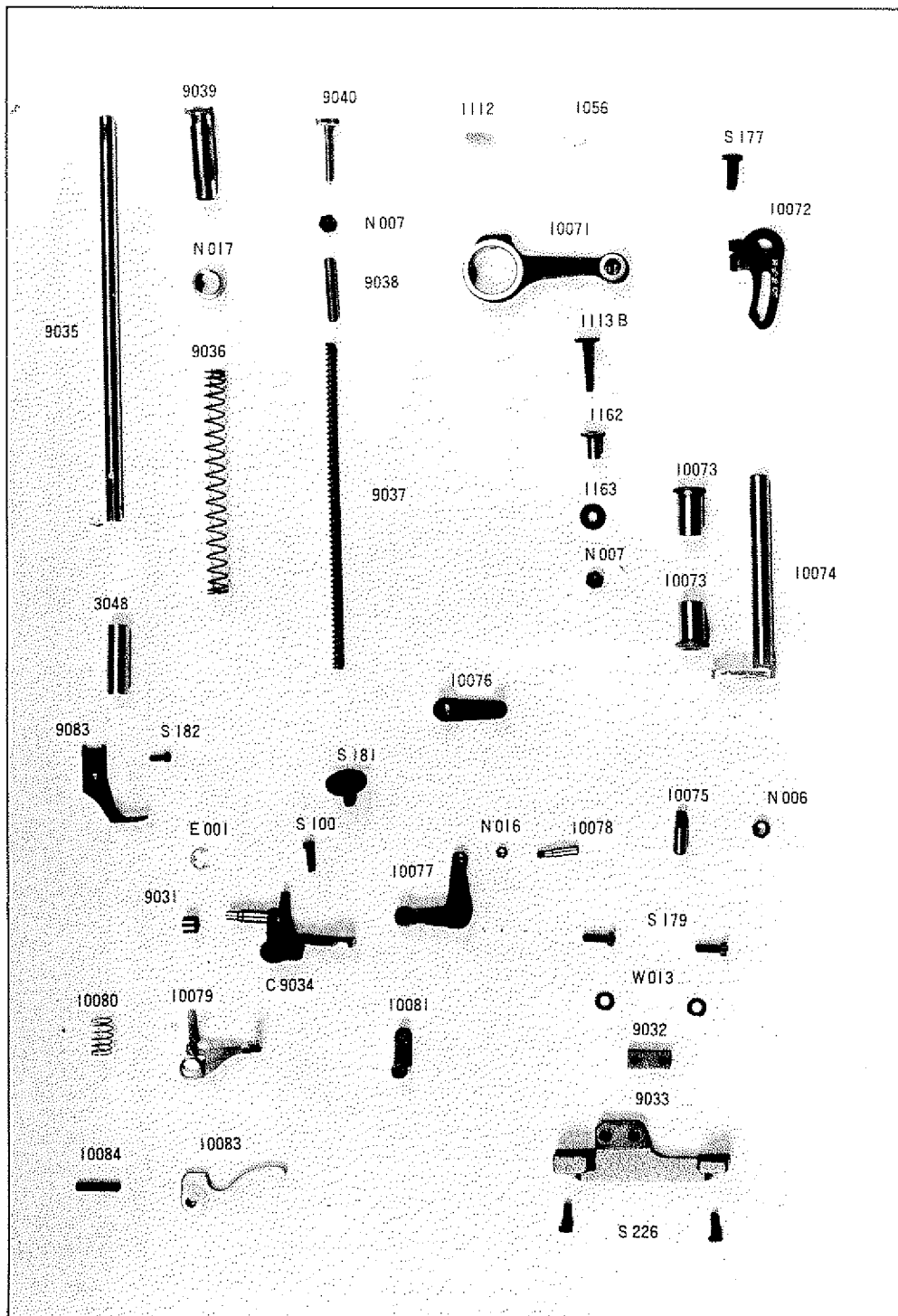

品番 Part. No.	品名	Description	数量 Amt. Req.
1056	上送りロットフェルト押エ	Oil felt spring	1
1112	上送りロットフェルト	Oil felt	1
1113B	上送りロット連結段ネジ	Screw stud	1
N007	ナット	Nut	1
1162	上送りロット連結軸	Lifting eccentric connection collar	1
1163	上送りロット連結段ネジ座金	Lifting eccentric connection washer	1
3048	押エ棒下メタル	Presser bar bushing	1
9031	押エ上ゲテコ台結合軸コロ	Connecting pin roller	1
E001	押エ上ゲテコ台結合軸Eリング	Snap ring	1
9032	押エ上ゲテコガイド板	Presser bar bracket position guide	1
S179	止ネジ	Screw	2
W013	座金	Washer	2
9033	押エ上ゲテコガイド板土台	Presser bar bracket position guide supporting base	1
S226	止ネジ	Screw	2
C034	押エ上ゲテコ台	Presser bar guide bracket	1
S100	締ネジ	Screw	1
S181	押エ上ゲテコ案内段ネジ	Hinge screw	1
9035	押エ棒	Presser bar	1
9036	押エ調節バネA	Presser spring(A)	1
9037	押エ調節バネB	Presser spring(B)	1
9038	押エ調節バネB案内軸	Presser spring(B) guide pin	1
9039	押エ調節ネジA	Presser regulating thumb screw(A)	1
N017	ナット	Nut	1
9040	押エ調節ネジB	Presser regulating thumb screw(B)	1
N007	ナット	Nut	1
9083	押エ足	Presser foot	1
S182	止ネジ	Screw	1
10071	上送りロット	Upper feed driving rod	1
10072	上送り腕	Upper feed spring rod	1
S177	締ネジ	Screw	1
10073	上送り軸メタル	Bushing	2
10074	上送り軸	Upper feed driving shaft	1
10075	上送り連結段ネジ	Screw stud	1
N006	ナット	Nut	1
10076	上送り連結リンク	Connecting link	1
10077	L型リンク	L shaped link	1
10078	L型リンク結合軸	L shaped link connecting screwstud	1
N016	ナット	Nut	1
10079	糸ユルメ受板	Thread release guide	1
10080	糸ユルメ受板バネ	Thread release spring	1
10081	上送り揺動リンク	Walking bar driving link	1
10083	押エ上ゲ	Hand lifter	1
10084	押エ上ゲ軸	Hand lifter pin	1

From the library of Diamond Needle Corp

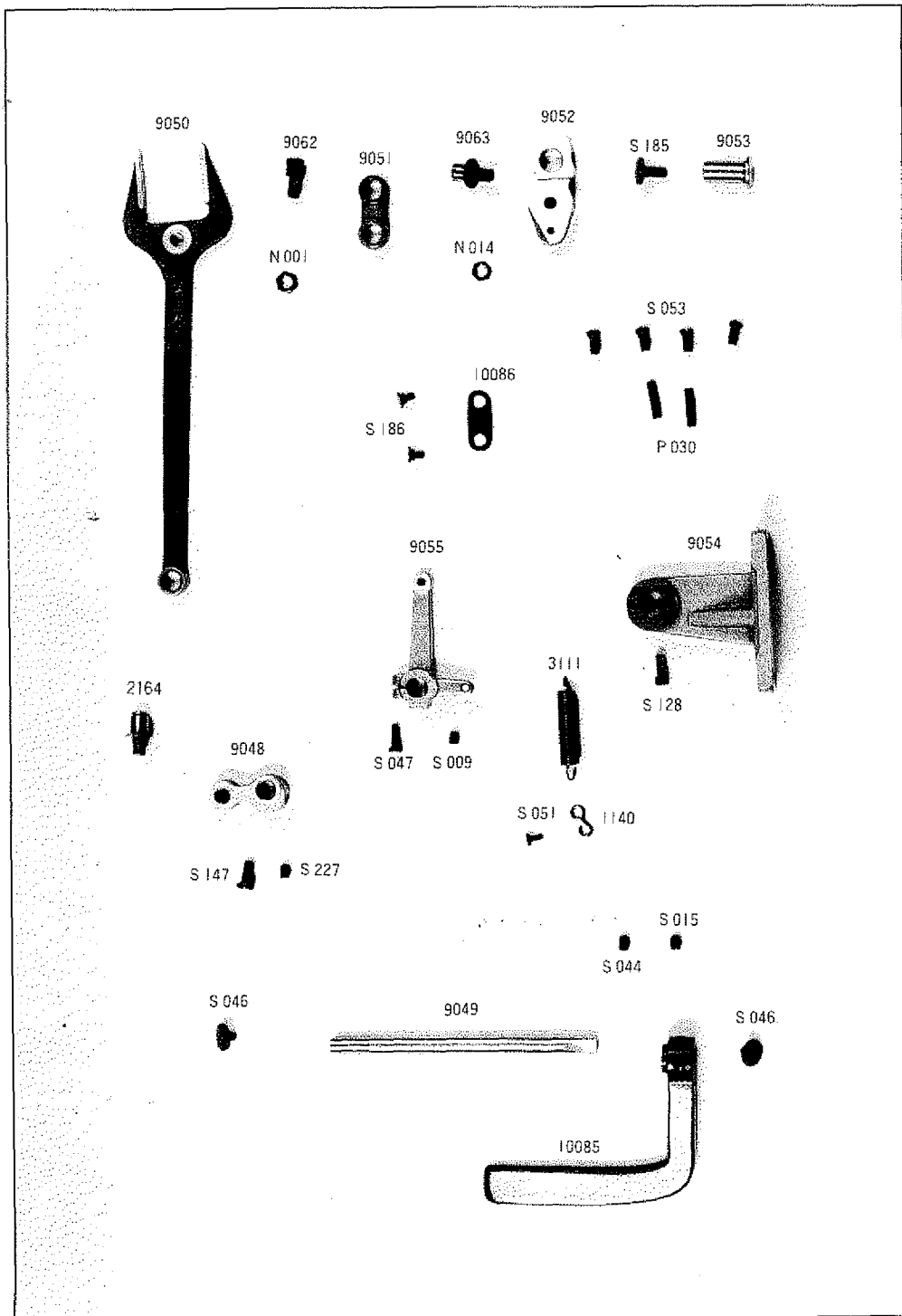

品番 Part. No.	品名	Description	数量 Amt. Req.
1140	引張りバネ掛ケ	Spring suspension hook	1
S051	" 止ネジ	···· Screw	1
3111	引張りバネ	Tension spring	1
9048	水平送り腕	Feed rock shaft crank	1
S227	" 止ネジ A	···· Screw(A)	1
S147	" 止ネジ B	···· Screw(B)	1
2164	二又ロッド段ネジ	Screw stud	1
9049	送り調節レバー軸	Reverse feed control lever shaft	1
S046	" 押ネジ	···· Screw	2
9050	二又ロッド	Pitman	1
9051	二又リンク	Feed connecting link	1
9052	送り調節台	Feed regulator	1
9053	送り調節台止軸	Feed regulator hinge pin	1
S185	" 押ネジ	···· Screw	1
S128	" 止ネジ	···· Screw	1
9054	送り調節台主台	Feed regulator supporting base	1
S053	" 止ネジ	···· Screw	4
P030	" 止ピン	···· Spring pin	2
9055	送り調節腕	Reverse feed control lever crank	1
S009	" 止ネジ	···· Screw	1
S047	" 締ネジ	···· Screw	1
9062	二又ロッド段ネジ A	Feed regulator connecting link hinge screw(A)	1
N001	" ナット	···· Nut	1
9063	二又ロッド段ネジ B	Feed regulator connecting link hinge screw(B)	1
N014	" ナット	···· Nut	1
10085	送りレバー	Reverse feed control lever	1
S044	" 止ネジ A	···· Screw(A)	1
S015	" 止ネジ B	···· Screw(B)	1
10086	送り調節腕リンク	Feed regulating link	1
S186	" 段ネジ	···· Screw	2

From the library of Diamond Needle Corp

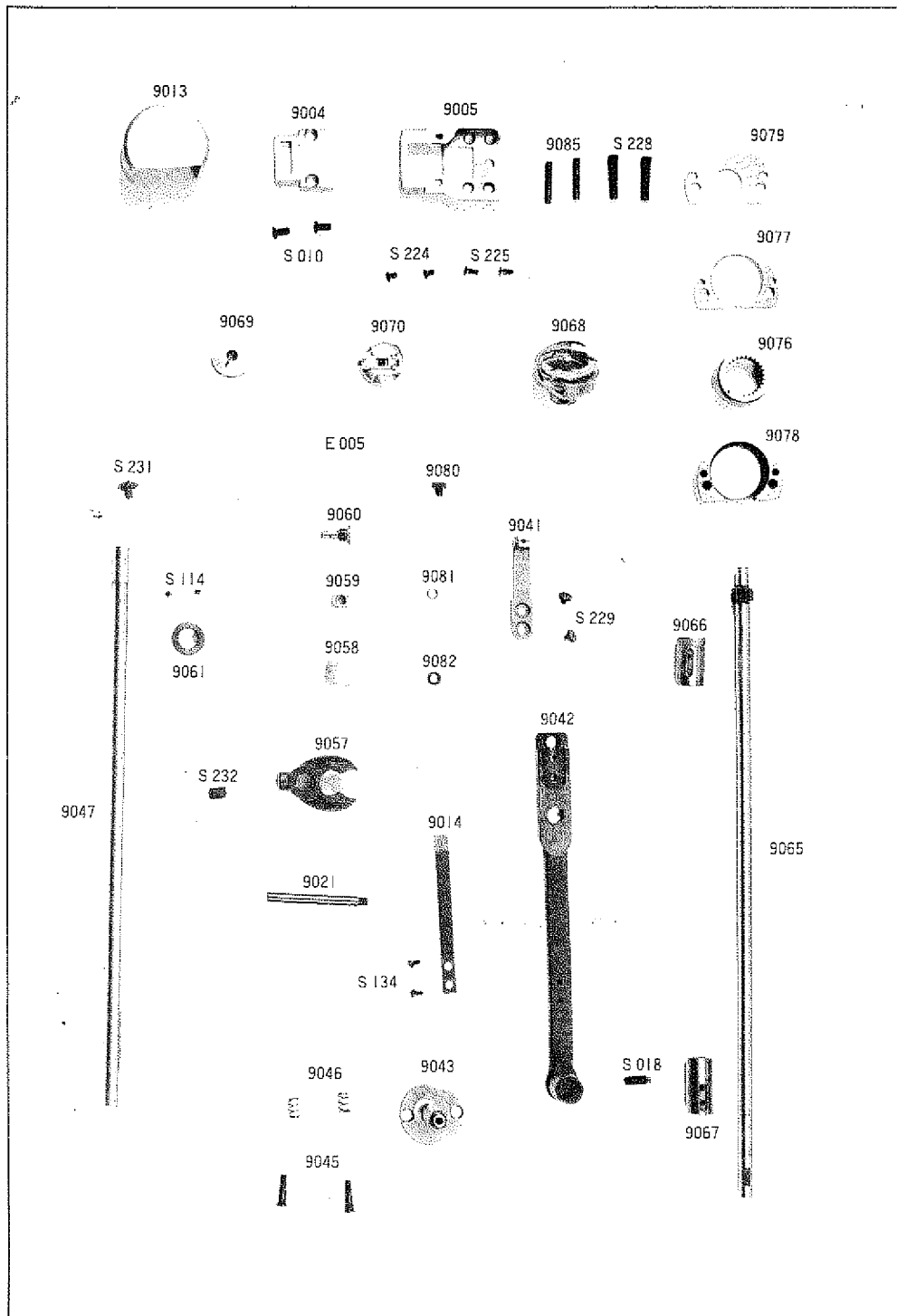

品番 Part. No.	品名	Description	数量 Ami. Req.
9004	針板	Throat plate	1
S010	" 止ネジ	· · · Screw	2
9005	針板台	Throat plate base	1
S224	" 止ネジ	· · · Screw	2
S225	" 止ネジ	· · · Screw	2
9013	釜カバー	Hook cover	1
9014	バネ	Feed bar spring	1
S134	" 止ネジ	· · · Screw	2
9021	バネ支エ軸	Screw stud	1
9041	送り	Feed dog	1
S229	" 止ネジ	· · · Screw	2
9042	送り台	Feed bar	1
9043	送り台軸	Feed bar stud	1
9045	" 止ネジ	· · · Screw	1
9046	" 止ネジバネ	· · · Spring	1
9047	水平送り軸	Feed rock shaft	1
S231	" 止ネジ	· · · Screw	1
9057	送り台揺動腕	Feed rocker	1
S232	" 止ネジ	· · · Screw	1
9058	送り台駒A	Feed bar slide block(A)	1
9059	" B	· · · (B)	1
9060	送り台駒軸	Feed bar slide block screw stud	1
E005	" Eリング	· · · Snap ring	1
9061	水平送り軸スラスト受ケ	Feed rock shaft thrust collar	1
S114	" 止ネジ	· · · Screw	1
9065	下軸	Hook driving shaft	1
9066	下軸前メタル	Hook driving shaft front bushing	1
9067	下軸後メタル	Hook driving shaft rear bushing	1
S018	" 止ネジ	· · · Screw	1
9068	釜	Hook	1
9069	ボビン	Bobbin	1
9070	ボビンケース	Bobbin case	1
9076	上下カム	Feed driving cam	1
9077	上下カム受板A	Feed driving cam holder(A)	1
9078	" B	· · · (B)	1
9079	上下カム受板蓋	Feed driving cam holder plate	1
S228	" 止ネジ	· · · Screw	2
9085	" 止ピン	· · · Pin	2
9080	送り台足	Feed bar slide pin	1
9081	送り台足座金	· · · Washer	1
9082	送り台足止ナット	· · · Nut	1

From the library of Diamond Needle Corp

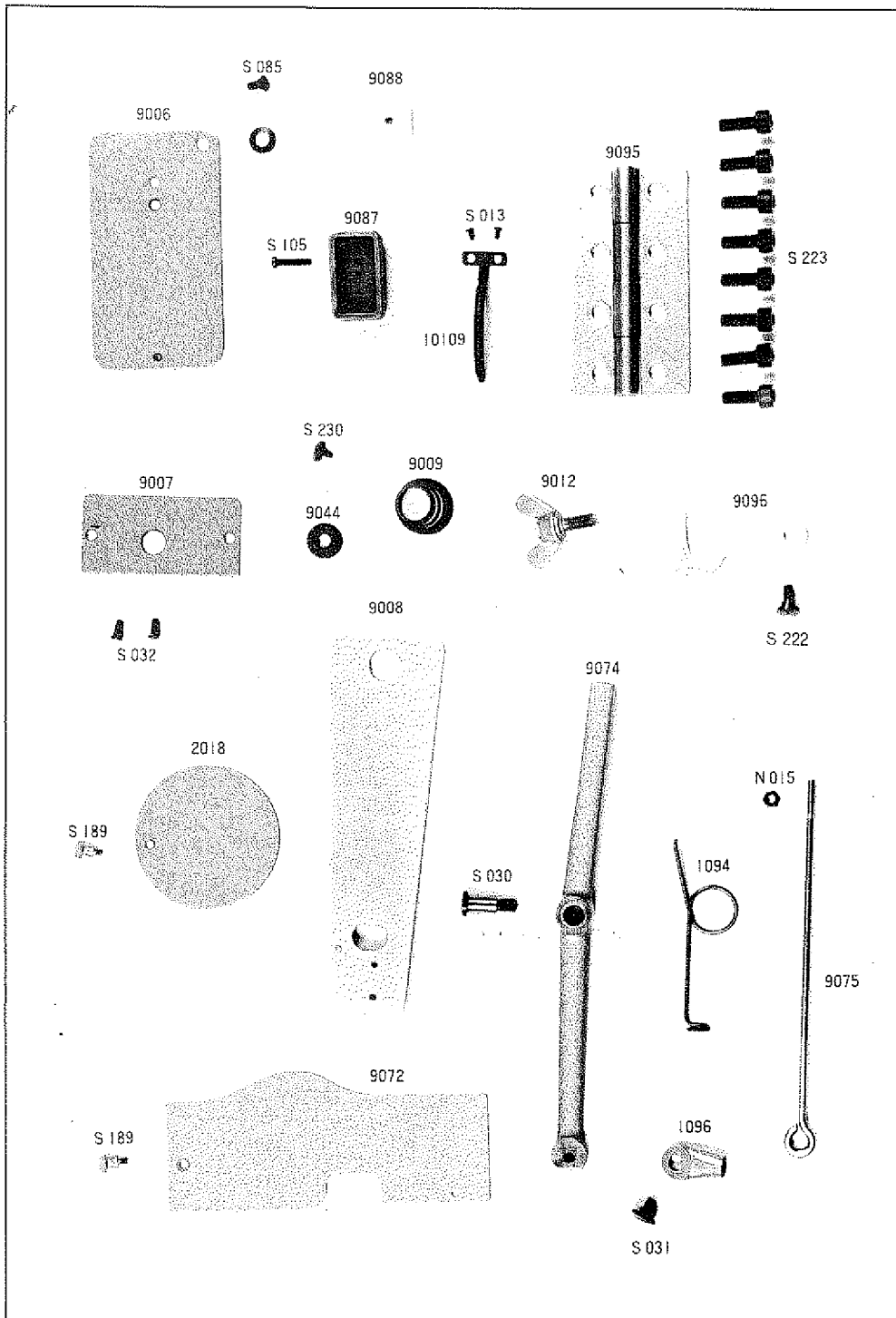

品番 Part. No.	品名	Description	数量 Amt. Req.
1094	膝上ゲテコバネ	Knee lifter lifting lever spring	1
1096	吊棒ダルマ	Joint	1
S031	止ネジ	Screw	1
2018	ベッド窓板	Bed side plate	1
S189	止ネジ	Screw	2
9006	天板	Top cover	1
S085	止ネジ	Screw	2
9007	窓板	Side plate	1
S032	止ネジ	Screw	2
9008	ベッド上面カバー	Bed cover	1
9009	ベッド上面カバーバネ	Bed cover spring	1
9044	送り台軸蓋	Washer	1
S230	ネジ	Screw	1
9072	面 板	Face plate	1
9074	膝上ゲテコ	Knee lifter lifting lever	1
S030	段ネジ	Screw	1
9075	後吊り棒	Lifting lever connecting rod	1
N015	吊棒ダルマ止ナット	Nut	1
9012	掛金止蝶ネジ	Thumb screw	1
9087	油 溜	Oil reserveir	1
S105	止ネジ	Screw	1
9088	油溜フェルト	Felt	1
9095	蝶 番	Bed hinge	1
S223	止ネジ	Screw	8
9096	掛 金	Latch	1
S222	段ネジ	Screw	1
10109	油芯支エ金具	Oil wick holder plate	1
S013	止ネジ	Screw	2

From the library of: Diamond Needle Corp

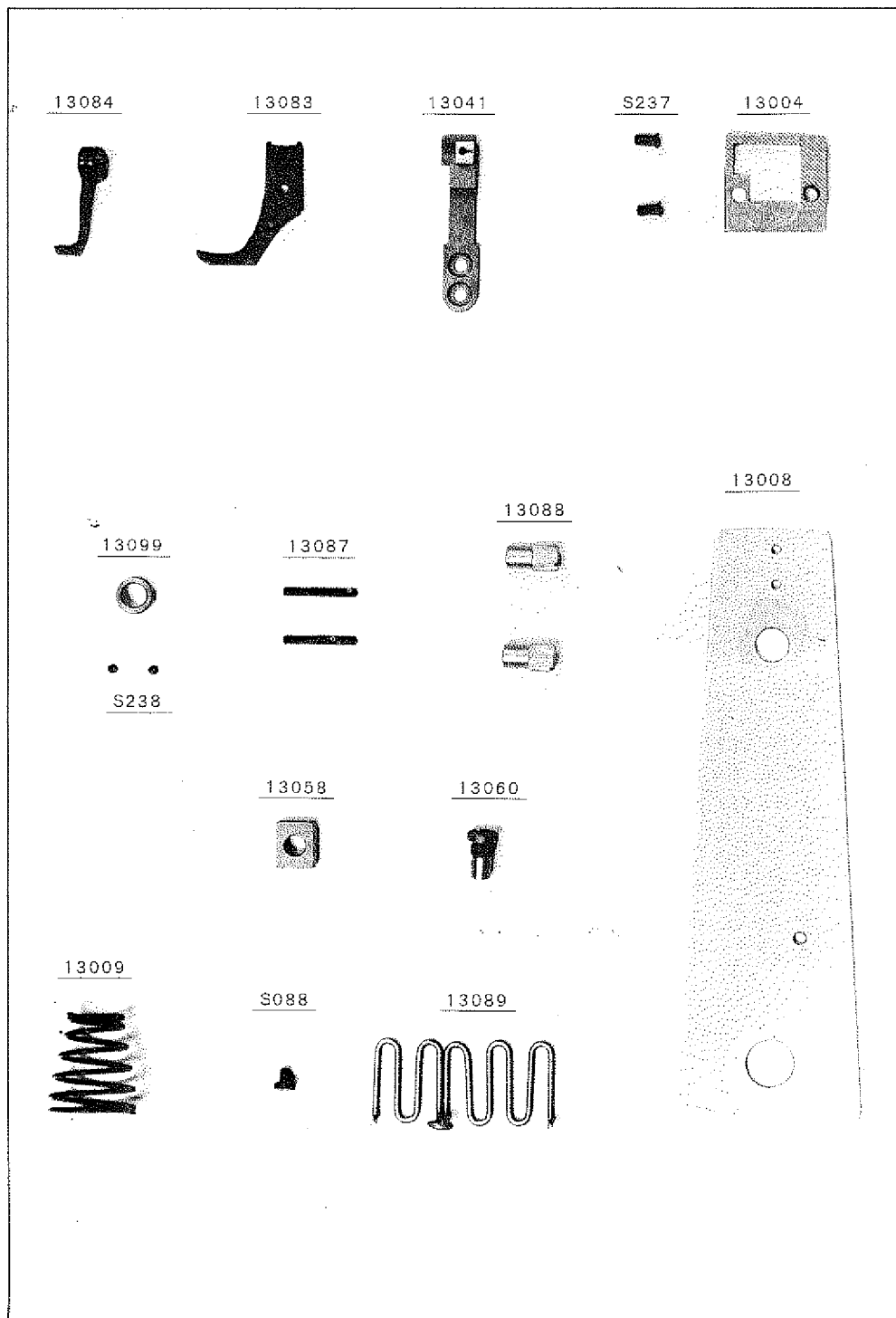

品番 Part. No.	品名	Description	数量 Amt. Req.
13004	針板	Throat plate	1
13008	ベッド上面カバー	Bed cover	1
13009	ベッド上面カバーバネ	Bed cover spring	1
13041	送り	Feed dog	1
13058	送り台駒	Feed bar slide block	1
13060	送り台駒軸	Feed bar slide block screw stud	1
13083	押エ足	Presser foot	1
13084	上送り足	Walking foot	1
13087	バインダー止ネジ	Binder supporting screw	2
13088	バインダー止ナット	Binder supporting screw nut	2
13089	テープガイド	Tape guide	1
13099	下軸スラスト受	Hook driving shaft thrust collar	1
S088	テープガイド止ネジ	Tape guide supporting screw	1
S237	針板止ネジ	Throat plate screw	2
S238	下軸スラスト受止ネジ	Hook driving shaft thrust collar screw	2

From the library of: Diamond Needle Corp.